

**UMASC Farm Trial  
Monday September 4th, 2017  
Sheep & Ducks**

**Stock will be 10 head of sheep per run and 10 head of ducks per run.  
Maximum 10 sheep runs available and 10 ducks runs available  
Divisions: Advanced/Open**

**Location:  
Conroy Farm  
23145 Denmark Ave.  
Farmington Minnesota 55024**

**ASCA Sanctioned (pending)**

**Judge: Deb Conroy**

**ENTRY FEE:  
Sheep: pre-entry \$50.00 (day of show \$60.00)  
Ducks: Pre-entry \$40.00 (day of show \$50.00)**

**PRE-ENTRIES OPEN: July 10th, 2017 and close August 20th, 2017  
Entries will be accepted in postmark order.**

**Handlers meeting at 8:00am followed by sheep trial than ducks.**

**Bitches in season will run in order.**

**AWARDS: Ribbons for 1st-4th place in each division.**

**ASCA Farm Trial rules will be followed and can be viewed at [asca.org](http://asca.org)  
Entries must be made on a official ASCA form available at [asca.org](http://asca.org)**

**Checks payable to: UMASC  
Mail Entries to:  
Conroy Farm  
23145 Denmark Ave  
Farmington, MN 55024**

**Course Director:  
Greg Byrne : [desperadoaussies@yahoo.com](mailto:desperadoaussies@yahoo.com) 651-269-7722  
Show Secretary: Tom Conroy [conroyfarm@hotmail.com](mailto:conroyfarm@hotmail.com) 651-463-3471**

**See attached sheets for diagram and description of the courses.**

**Running order draw will be done prior to trial on Sept 1, 2017**

**Entry fee will only be refunded if your run is filled.**

**Owner of dog is responsible for any veterinary expense to stock. Replacement cost will be \$200.00 sheep and \$35.00 for ducks.**

**Camping on grounds @ \$10.00 per night. No hook-ups.**

**Motel 6: 11274 W 210th St. Lakeville, MN. 55044  
952-469-1900**

**Veterinarian on call: Farmington Vet Clinic 651-463-8985**

**NO LUNCH ON GROUNDS so bring a bag lunch or fast food 1 mile away.**

**Entrants are responsible for all damage caused by themselves, their dogs and their family members.**

**UMASC/ members/ the Conroy family assume no responsibility for any accident, injury or loss.**

**All dogs must be leashed when not working.**

**ASCA's bite incident policy will be enforced.**

## SHEEP FARM TRIAL

20 minute with a warning at 10 minutes and 3 minutes  
Tie is broken by fetch than sort. Set out dog will be used as needed.

1. Pen Work (5 pts) Take 5 sheep from holding pen 1 and put into Pen A.
2. Pen Work (5pts) Take 5 sheep from holding pen 2 and also put into Pen A. Handler and dog exit to Arena B.
3. Pen Work (10pts) Take the 10 sheep out of Pen A and put into Arena B.
4. Gather (20pts) Handler and dog go to cone 1 for gather. Advanced handler must stay at cone until gather is complete. Open handler must leave dog at cone 1 but can go half way to cone 2 before sending dog. Gather sheep around cone 1 than gather/ or drive back to Pen A and put them back into Pen A. Handler and dog exit.
5. Pen Work (5pts) Take sheep from west side of Pen A and put into chute area.
6. Chute Work (20pts) Load the 10 sheep into chute. Advanced handlers must stay behind handlers line ( 10ft from chute) until sheep are loaded than they can move to close end gate. Open handlers has no restrictions. Ribbon 5 sheep while in the chute. Take sheep from chute and exhaust into Arena C.
7. Trailer load (20pts) Load sheep into trailer and close gate. Open handler will have a wing panel to help load. Advanced handlers will load without wing panel. Exhaust sheep from trailer into Arena C.
8. Hold in designated area. (20pts) Take sheep and hold in designated area until judge tells you it is a "HOLD" Return sheep to Pen A.
9. Sort (25pts) From Pen A sort 5 marked (ribbon) sheep into holding Pen 1. Sort 5 remaining sheep into holding Pen 2.

End of run.

Holding Pens 1 & 2: 10ft x 8ft.

Pen A: 20ft x 20ft

Arena B: 150ft x 250ft

Chute area: 60ft x 80ft

Chute: 16ft long

Gather: 150ft

Arena (Pen) C: 150ft x 245ft

Trailer: 16ft

Hold area: 25ft circle

# UMASC FARM TRIAL SHEEP

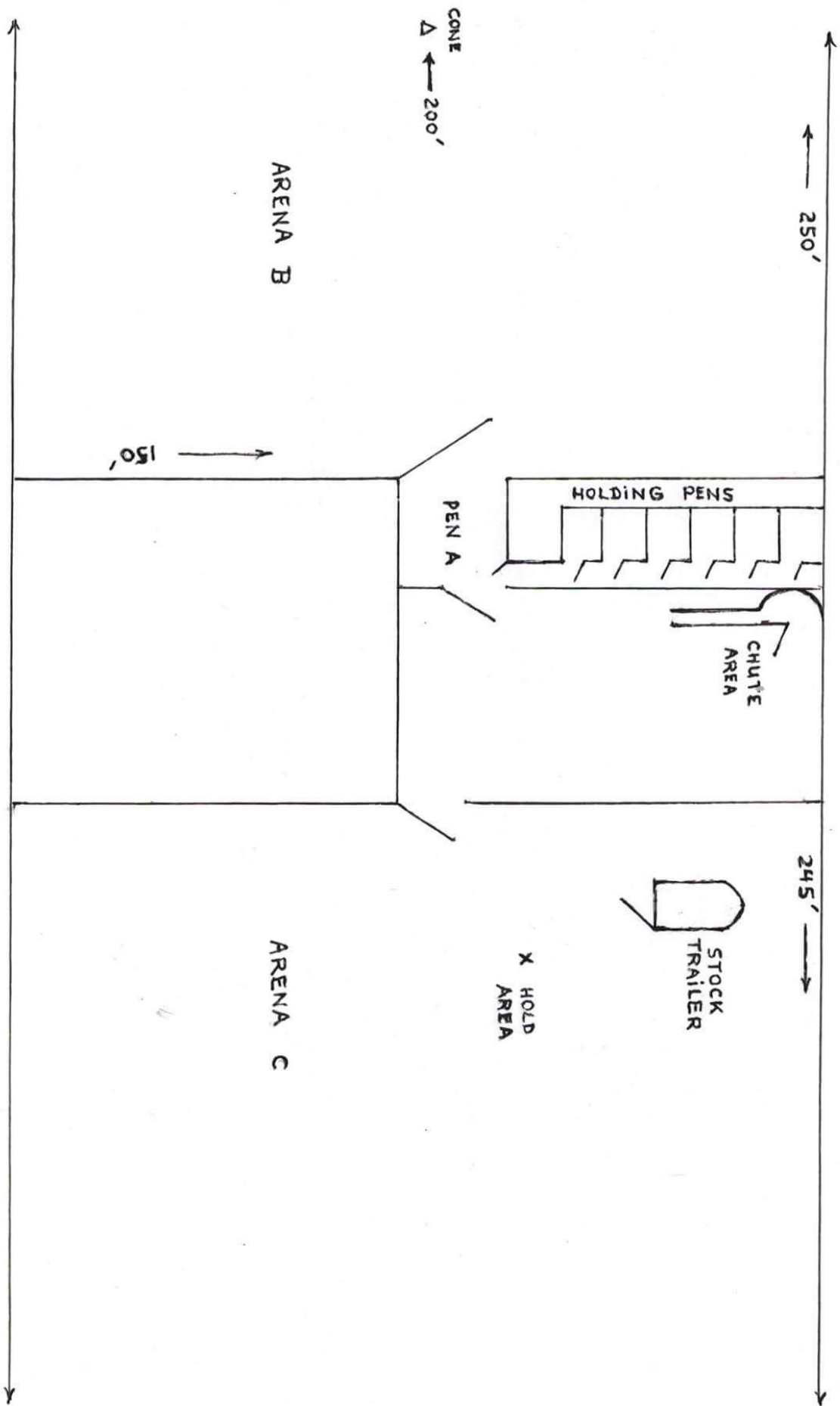

## DUCK FARM TRIAL

17 minute limit with a 3 minute warning.

Tie broken by fetch than sort.

No set out dog used.

1. Pen Work (5pts) Take 5 ducks from holding Pen 1 and put into Pen A.
2. Pen work (5pts) Take 5 ducks out of holding Pen 2 and also put them into Pen A. Handler and dog exit to Arena B.
3. Pen work ( 10pts) Take the 10 ducks from Pen A and put into Arena C.
4. Gather (20pts) Handler and dog go to cone 1 for gather. Advanced handlers must stay at cone. Open Handlers must leave dog at cone 1 and may go half way to cone 2 before sending dog on gather. Gather ducks to cone 1.
5. Hold ( 20pts) Take ducks to designated HOLD area. Hold until judge tells you it is a HOLD.
6. Chute (20pts) Load ducks into chute. Advanced handlers must stay behind handlers line until ducks are loaded into chute than they can cross the line to close end gate. ( Handlers line 10ft from chute) Open handlers have no restrictions. While in chute spray ducks for parasites. Release ducks into Pen B.
7. Pen Work (5pts) Remove ducks from Pen B and put into Arena C.
8. Wagon/Trailer Load (20pts) Load ducks onto wagon. Advanced handlers must stay behind handlers line until wagon is loaded than they may cross line to close gate. ( Handlers line 10ft from wagon) Ramp to wagon has a wing on to load with. Take wagon and transport ducks to Pen A. Unload ducks and put into Pen A.
9. Sort (25pts) From Pen A sort off the 5 marked ducks and put into holding Pen 1. Put remaining 5 ducks into holding Pen 2.

End of run.

Holding Pen: 1 & 2: 5ft x 5ft

Pen A: 12ft x 12ft

Arena C: 100ft x 100ft

Chute: 10ft

Pen B: 12ft x 12ft

Hold area: 10ft circle



UMASC FARM TRIAL

DUCKS

