

**UPPER MIDWEST AUSTRALIAN SHEPHERD CLUB**

**Pine County Corn Classic  
June 19-21, 2009**

**ALL BREED ASCA STOCKDOG AND FARM TRIAL  
MVA offered on Saturday, June 20th!**

ASCA RULES  
ASCA Sanction Pending

**Friday June 19, 2009**

**Judge:** Becky Beckmann

**Sheep and Duck Farm Trial** (see following pages for course and description)

(9 sheep and duck runs available)

**Cattle Trial** Course B (9 runs available)

Check-In/Day of Show Entries: 8:00 a.m.

Handler's Meeting Farm Trials: 8:30 a.m.

Farm Trial starts : 9:00 a.m.

Handler's meeting for Cattle Trial will begin after completion of Farm Trials with trial starting immediately after the Handler's Meeting.

Awards will be given out for all runs after completion of Cattle Trial.

**Saturday June 20, 2009**

**Stock Judges:** Kaye Harris (Sheep Course A) and Wayne Harris (Cattle and Ducks Course B)

21 Sheep Runs

10 Cattle Runs

16 Duck Runs

**MVA Evaluation Judge:** Karen MacDonald

**Obedience Judge:** Kathy Sianko (Aussies only- Will be held outdoors)

Order: Utility/Open A/ Open B/ Novice A/ Novice B/ Sub-Novice

Limit of 12 Entries

Check-In/Day of Show Entries: 7:00 a.m.

Stock Handler's Meeting: 7:15 a.m.

**Stock Trial starts:** 7:30 a.m. (Cattle first- Sheep and Ducks run simultaneously)

**MVA Evaluation:** Held from 9:30 a.m. To 10:30 a.m. Entrants will be responsible to have their dog evaluated in that time frame. We will work around stock run conflicts if needed.

**Obedience Trial starts:** 11 a.m. We will work around stock run conflicts if needed.

Awards will be given out after stock trial and obedience trials are completed.

**Sunday June 21, 2009**

**Stock Judges:** Kaye Harris (Cattle and Ducks Course B) Wayne Harris (Sheep Course A)

21 Sheep Runs

10 Cattle Runs

16 Duck runs

Check-In/Day of Show Entries: 7:00 a.m.

Stock Handler's Meeting: 7:15 a.m.

**Stock Trial starts:** 7:30 a.m. (Cattle first- Sheep and Ducks run simultaneously)

All pre-entries must be postmarked on or after May 1 and by June 15, 2009. No pre-entries will be accepted with a postmark before May 1st!  
**Sorry, no phone or email entries!**

**Please state clearly on entry form which dates and what classes you are entering.**

All non-aussie entrants must be registered with a tracking number from ASCA to receive titles. See ASCA website for details. You may also register for a tracking number at the trial. [www.asca.org](http://www.asca.org)

Entries will be accepted in postmark order. In the case of duplicate postmark entries a random draw will be made of those entries to determine the order of acceptance. Run order will be drawn on June 17<sup>th</sup>. **Correct entry fee must accompany an official, signed, and FULLY completed ASCA entry to be considered a valid entry.** Forms are available on the ASCA website. [www.asca.org](http://www.asca.org) Day of show entries will be allowed if space is available. A waiting list will be established if the trial fills. **Entry fees will only be refunded if the trial AND your spot is filled.** Bitches in heat will run in the order of the draw.

Make checks payable to: **UMASC**

Send entries to: Kim Schneider  
23322 Russell Road  
Pine City, MN 55063

Course Director: Kim Schneider

Phone: H: 320-629-1068 cell: 651-332-6778 email: [hzbtt@aol.com](mailto:hzbtt@aol.com)

Show Secretary: Kathy Sianko

Please include your email address on the entry form and we will confirm that your entry was accepted or if you are on the waiting list. If you do not have email, please enclose a self-addressed stamped postcard.

Entrants are responsible for all damage caused by themselves, their dogs, and their family members. UMASC/& members/& the Schneider family assume no responsibility for any accident, injury, loss or theft. Please stay in the designated areas. Please clean up after your dogs. **DO NOT POTTY OR EXERCISE DOGS ON ANY ONE ELSE'S PROPERTY OTHER THAN THE HOST SITE.** All dogs must be **ON LEASH** at all times. Failure to comply with the above will result in the entrant being asked to leave and no refunds to be given.

**Directions:**

Elysian Farm  
Joe and Kim Schneider  
23322 Russell Road  
Pine City, MN 55063  
H: 320-629-1068 C: 651-332-6778  
[hzbtt@aol.com](mailto:hzbtt@aol.com)

From I35 North: Take 35 North to Exit 165/County Road 70 (Rock Creek Exit). Head east (right) till you reach the 4 way stop. At the stop take 361 North (left). Follow 361N to County Road 117 /Liberty Road (1.3 mi). Head east (right) on 117/Liberty Road. Follow the road until it stops (2 mi). Head north (left) on County Road 4/Military Road/Government Road. This is a paved road. From County Road 4 head north until you reach Russell Road (.6 mi). Head east (right) on Russell Road. Elysian Farm will be the 3rd house on your right (.6 mi). Our driveway is not paved. Please use caution when driving or parking if it is wet out.  
Veterinarian on Call: Pine City Veterinary Clinic:320-629-7591

Volunteers are needed to help the trials run smoothly. Timers, scorekeepers, stock handlers, runners, are always needed and APPRECIATED! If you would like the trials to continue please help wherever you can when you are not running a dog. Thank you!!!!!!!!!!!!!!

**There will be a potluck lunch immediately following Saturday's awards. Joe and I will provide a main dish. (to be announced closer to date).**

Pre-Entry Fees:	Day of Entry Fees:
Cattle: \$40.00	\$50.00
Sheep: \$ 30.00	\$35.00
Ducks: \$ 20.00	\$25.00
Sheep Farm: \$45.00	\$ 50.00
Duck Farm: \$35.00	\$40.00
Open Working Junior: Same as above	
Working Junior and Pee-Wees(Ducks only): \$10.00	
Obedience: \$15.00	
MVA Evaluation: \$5.00	

Specials available Pre-Entry Only!

Friday Special: Cattle Run, Sheep Farm Trial Run and Duck Run for same dog: \$105.00

Saturday Special: Cattle Run, Sheep Run, Duck Run, MVA evaluation, Obedience Entry for same dog: \$100.00

Sunday Special: Cattle Run, Sheep Run, Duck Run for same dog: \$85.00

#### **Awards:**

##### **Friday:**

High Sheep Farm Trial

High Duck Farm Trial

High Cattle

High Combined (Scores taken from High qualifying scores in all 3 classes. )

High Working Junior

High Open Working Junior

##### **Saturday:**

High Cattle

High Sheep

High Duck

High Combined (Scores taken from High Qualifying scores in all 3 classes)

Most Promising Started Aussie ( Qualifying scores taken from all 3 classes- if there are not 3 qualifying scores than the highest 2 qualifying scores will be used)

High Working Junior

High Open Working Junior

Pee-Wee Participation

High Obedience

MVA Award (Will be decided by adding all qualifying stock awards, MVA evaluation score and score (qualifying or not) from obedience)

##### **Sunday:**

High Cattle

High Sheep

High Duck

High Combined (Scores taken from High Qualifying scores in all 3 classes)

Most Promising Started Aussie ( Qualifying scores taken from all 3 classes- if there are not 3 qualifying scores than the highest 2 qualifying scores will be used)

High Working Junior

High Open Working Junior

Pee-Wee Participation

## ASCA Duck Farm Trial Course Description

- Handler and Dog will be waiting at Cone A
- 10 Head of ducks will be set into Arena #1 near marked set out area
  - Open Handlers may walk to Cone B and send their dog to gather ducks to them (25 available points)
  - Advanced Handlers must stay at Cone A and send their dog to gather ducks to them (25 available points)
- After ducks have been gathered to handler the stock will be taken across the bridge with the stock entering the south entrance and exiting the north entrance (15 available points)
- Sort 5 head of ducks in sort area and take out of gate #1. Leave remaining 5 in Arena #1. (25 available points)
- Advanced handlers will take their 5 sorted ducks and proceed to Hold area #1 and place ducks in or near kiddie pool for 15 seconds or until judge calls "That's a hold". (15 available points)
- Open Handlers will take their 5 sorted ducks and proceed to Hold area #2 located in Arena #2 and place ducks in or near kiddie pool for 15 seconds or until judge calls "That's a hold". (15 available points)
- All Handlers/dogs will return ducks to Arena #1 and will put 10 head of ducks through chute. It has guillotine gates (25 available points).
- Handlers/dogs will put 5 head of ducks into Pen #1 and 5 head of ducks into Pen #2 after they are put through the chute. They will then take all ducks out of Pen #1 and Pen #2 and put them into Pen #3 (25 available points).

End of Trial!

Time limit is 15 minutes with a 3 min. warning called. Please note, all gates must be closed before time is up.

To earn a qualifying score Open and Advanced Farm Trial dogs must earn 70% or more of the total points (91/130). Any ties will be broken by the highest score under the Pen work section. A dog must have two qualifying Duck Open Farm Trial scores under two different judges to enter the Advanced Duck trial class.

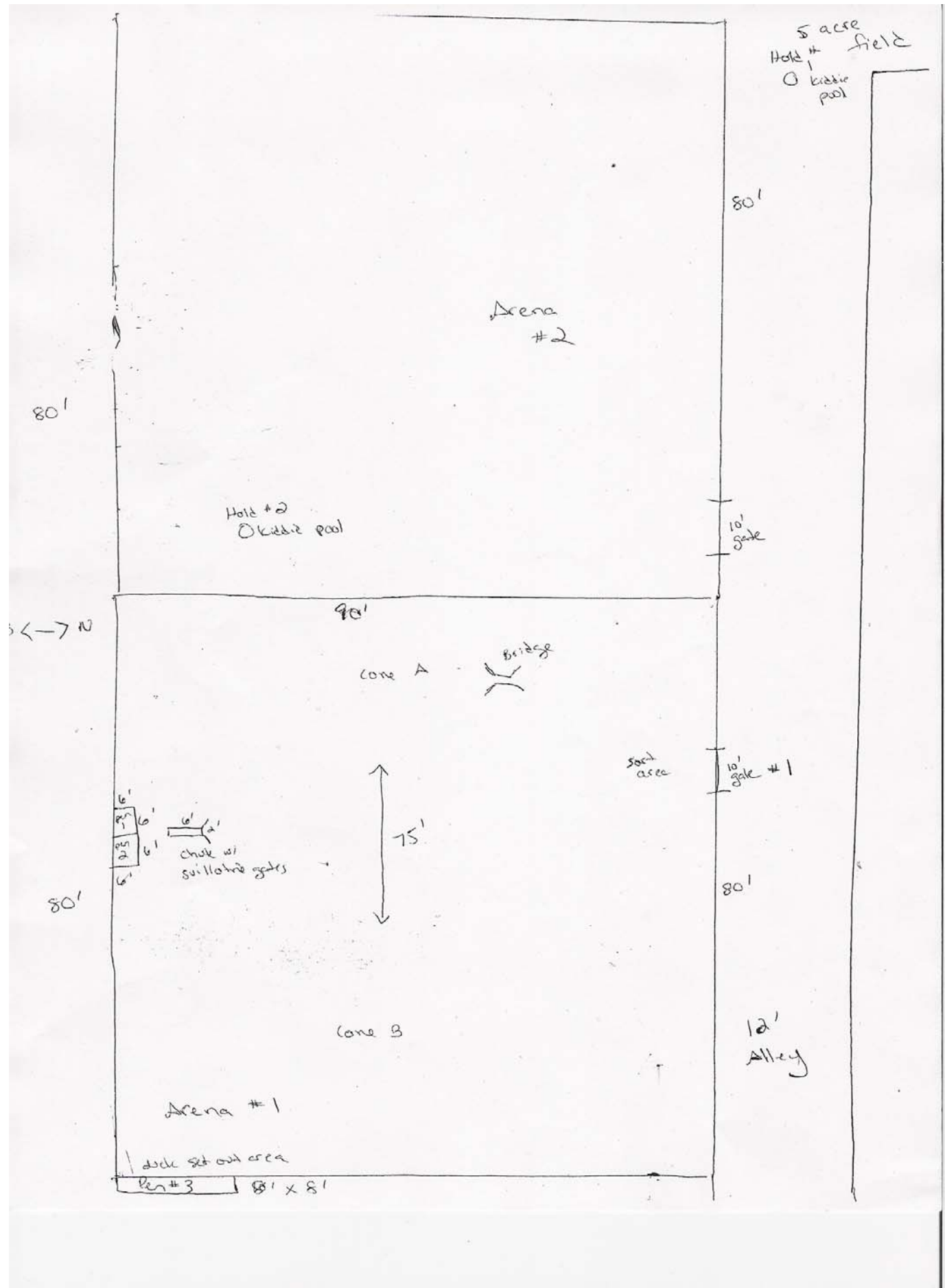

## ASCA Sheep Farm Trial Course Description

Kim has decided to show hamsters and the prestigious “Rodent Rally” is the same weekend.. Since Kim has to prepare Fluffy and Chewie for the show you are all pitching in to get the new sheep vaccinated, medicate hooves and get them grouped and ready for the trial. Joe graciously offered to help be in charge of everything. The reason the advanced handlers have to go out into the pasture is because he couldn't make up his mind whether it was OK for the sheep to dry off in the arena or not. The open handlers do not have to go out because someone convinced him not to worry about it. :)

- Handler and Dog will be waiting at Post A

- 8 head of stock will be set into Arena 1

- Open Handlers may walk to Post B and send their dog to gather sheep to them (25 available points)

- Advanced Handlers must stay at Post A and send their dog to gather sheep to them(25 available points)

-After sheep have been gathered to the handler, the dog and handler will take stock to the 12 foot entrance of the chute (the one with Guillotine gates). Handler will mark 3 head of sheep and than push all sheep through the chute exiting the 18” exit. (25 available points)

-Put all stock through the foot bath (must enter through 7' entrance and exit 18” exit). (15 available points)

- Open Handlers and Dog will take stock out of the chute and hold all stock at the marked “drying area” for 15 seconds or until the judge calls “That's a Hold” (15 available points)

- Advanced handlers and Dog will take stock out of the chute, take them out of the main gate and into the 5 acre field. They will fetch or drive sheep to Cone C and hold all stock there for 15 seconds or until judge calls “That's a Hold”. (15 available points)

- Once advanced and open handlers have held their stock they will then put the 8 head of stock into 12' x12' pen #2.

- Sort 3 marked head of stock into pen #5.

- Sort 3 head into pen #4

- Sort 2 head into pen #3

- Move stock from pen #' s 3,4, and 5 and place into pen #2. (25 available points for the above pen work)

End of Trial!

Time Limit is 15 minutes with a 3 minute warning called. Please note, all gates and guillotine style gates must be closed before time is up

To earn a qualifying score Open and Advanced Farm Trial Dogs must earn 70% or more of the total points (91/130). Any ties will be broken by the highest score under the Pen Work section. A dog must have two qualifying sheep Open Farm Trial Dog scores under two different judges to enter in the Advanced Farm Trial Dog class.

Please see diagram of course on next page. There will be ample opportunity to check gates and pens during the handler's meeting.

